



JURONG SECONDARY SCHOOL
LOYALTY • INDUSTRY • SINCERITY • LOVE

Release of 2025 GCE 'N' Level Results

18 Dec 2025





JOINT INTAKE EXERCISE (JIE) BRIEFING

JOINT INTAKE EXERCISE (JIE)

Computation of ELMAB3

- English, Mathematics & Best 3 subjects
- Combinations to compute the ELMAB3:
 - GCE N(A)-level results only
 - For students taking SBB subjects:
 - GCE N(A)-level + GCE O-level results
 - Firm offer after GCE “O” release
 - (i.e. only invited after GCE “O”)

JOINT INTAKE EXERCISE (JIE)

You will receive from your FT:

1. Results Slip

- Check your personal particulars like statutory name & Hanyu Pinyin name
- Amendment of particulars will cost **~\$50** per certificate. Requests must be submitted **by 26 December 2025 (Friday), 12pm, through the General Office**. Any requests received after this date will not be considered.

2. Form N

JOINT INTAKE EXERCISE (JIE)

If you lose your results slip and/or GCE 'N' Level certificates:

- School & MOE will **not** be able to replace the documents.
- You will have to request, at MOE, a statement of results. There will be a fee charged.
- You must bring your NRIC during the collection.

JOINT INTAKE EXERCISE (JIE)

If you wish to request an appeal of results:

- Fee of \$125 per subject appeal
- Must be supported with strong reasons
- All requests should be made through the Principal (candidate will need to complete an appeal form), with the payment of the appeal fees made through the Candidates Portal by **26 December 2025 (Friday), 12 pm.**



IMPORTANT DATES

Key Dates for Jan 2026 intake

1. All N(A)* / N(T) school leavers are encouraged to submit an application during the **1st Phase (Main Phase)** between **18 Dec 2025 (2.30pm) to 22 Dec 2025 (5pm)**. Application results for the 1st Phase will be released on **26 Dec 2025 from 9am**.
2. If you wish to appeal, please accept the course offered **before** applying in the **2nd Phase (Late Application/Appeal Phase)** between **26 Dec 2025 to 2 Jan 2026**. The application results for the 2nd Phase will be known on **6 Jan 2025 from 9am**.
3. Unsuccessful applicants can appeal under the **3rd Phase (Final Top-up Phase)** between **9 Jan and 16 Jan 2026 and 22 Jan to 6 Feb 2026** for courses with vacancies. The application results for the 3rd Phase will be known between **12 Jan and 22 Jan 2026** and **22 Jan and 11 Feb 2026**.

*N(A) students progressing to ITE

For further enquiries, N-Level school leavers can
contact
ITE Hotline: 1800-2222-111

To apply and find out more about the ITE JIE



For further enquiries, N-Level school leavers can
contact
ITE Hotline: 1800-2222-111

Key Dates for Jan 2026 intake

Key Activity	Period for 3-Year and 4-year Higher Nitec courses	Remarks
1st Phase (Main Phase)		
Application	18 Dec 2025 (2.30pm) to 22 Dec 2025 (5pm)	Apply at https://www.ite.edu.sg with SingPass.
Release of Results	26 Dec 2025	Check results at https://istudent.ite.edu.sg with web ID and password
Acceptance of Course Offer Period	26 Dec 2025 to 2 Jan 2026	Accept course offer at https://istudent.ite.edu.sg with web ID and password
2nd Phase (Late Application/Appeal Phase)		
Application	26 Dec 2025 to 2 Jan 2026	Apply at https://istudent.ite.edu.sg with SingPass.
Release of Results	6 Jan 2026	Check results at https://istudent.ite.edu.sg with web ID and password
Acceptance of Course Offer Period	6 Jan 2026 to 9 Jan 2026	Accept course offer at https://istudent.ite.edu.sg with web ID and password
3rd Phase (Final Top-up Phase)		
Application	1 st Top-up Phase Application - 9 Jan to 16 Jan 2026 2 nd Top-up Phase Application - 22 Jan to 6 Feb 2026	Apply at https://istudent.ite.edu.sg with SingPass.
Release of Results	1 st Top-up Phase - 12 Jan to 22 Jan 2026 2 nd Top-up Phase - 22 Jan to 11 Feb 2026	Check results at https://istudent.ite.edu.sg with web ID and password
Acceptance of Course Offer Period	1 st Top-up Phase - 12 Jan to 22 Jan 2026 2 nd Top-up Phase - 22 Jan to 11 Feb 2026	Accept course offer at https://istudent.ite.edu.sg with web ID and password
Jan 2025 Intake Term Commencement Date: <u>12 Jan 2026</u>		

Key Pointers for Students on ITE's Joint Intake Exercise (JIE)

ALL students in N(T) and N(A) students (who are not progressing to 5N(A) or repeating 4N(A)) are eligible for JIE.
Those who were unsuccessful in EAE are also eligible for JIE.

Apply in the 1st JIE main phase in December.

Use all 12 JIE choices wisely, as competition for 3-year Higher Nitec courses is keen!

Do consult your teachers / ECG counsellors to help you make your choices!

Do use the Last Aggregate Score (LAS) published in ITE's admission portal to help you make your course choices.

You are eligible for Enhanced Foundation Programme (EFP) if you receive an invitation letter to the EFP addressed to you and a copy of invitation letter for your parent/guardian.

If you are eligible for EFP, make sure you apply for both the 4-Year and 3-Year Higher Nitec Course.

The EFP helps to build the necessary literacy and numeracy foundations!

If you are counter-offered a course, accept it first to secure a place in ITE, before appealing for another course you may be more interested in!

Important Dates:

Option	Important dates	
PFP <i>Students to apply for 5NA first till O Level results release</i>	Application	Day of O Level results release in 2026
	Posting Results	Jan 2026
DPP <i>2-Year Higher NITEC</i>	Application	18 Dec (2.30pm) to 22 Dec 2025 (5.00pm)
	Posting Results	1 st Phase: 26 Dec 2025, 2 pm

Important Dates:

Option	Important dates	
Full Time Nitec Courses <i>3-Year & 4-Year Higher NITEC</i>	Application	18 Dec (2.30pm) to 22 Dec 2025 (5pm)
	Posting Results	1 st phase: 26 Dec 2025 (9am)
5NA	Application	18 Dec to 22 Dec 2025

Sec 5N Application/Withdrawal

For students applying for DPP:

1. Please apply for Sec 5N while awaiting for DPP outcomes. [Collect Form from GO]
2. Once you have accepted your DPP course, proceed to withdraw from 5N

For students applying for PFP:

1. Please apply for Sec 5N or DPP course while awaiting for PFP outcomes. [Collect Form from GO]
2. Once you have accepted your PFP course,
 - a) proceed to withdraw from 5N or
 - b) proceed to withdraw from ITE.

Important Dates:

Reporting day in 2026 :

Sec 5NA : **2 Jan 2026**

ITE : **12 Jan 2026**

NOTE:

*Whenever you are unsure of the dates, refer to **JIE Pamphlet pg 2**, depending on your options of courses*



INTERNET APPLICATION INSTRUCTIONS

Internet Application Instructions

- For students applying for **Higher Nitec Courses**:
→ Please refer to **JIE Pamphlet & the QR code provided**
- For students applying for **DPP Courses**:
→ Please refer to **JIE Pamphlet & the QR code provided**

NOTE:

Please keep the JIE Pamphlet as reference as it includes the instructions on checking of application, accepting and administration processes for your ITE courses.

Internet Application Instructions

3-Year Higher Nitec Courses

**4-year Higher Nitec Course with EFP
(for N(T) students with 0, 1 “N” pass)**

1. Go to <https://www.ite.edu.sg>.

2. Click  icon.

3. Under JIE ‘N’, click  icon to link to the application website

Under JIE ‘E’, click  icon to link to the application website

4. At the application website:

- a) Use your Singpass to access the application portal.
- b) Upon completion of application, applicants will receive their web ID and password.

Checking of Posting Results & Acceptance of Course Offer

3-Year Higher Nitec Courses

**4-year Higher Nitec Course with EFP
(for N(T) students with 0, 1 “N” pass)**

1. Go to <https://istudent.ite.edu.sg>.
2. Enter web ID and password.
3. Click '**Self-Service**' followed by '**Student Admission**' followed by '**View Application Results**' to view the application results and to accept course offer.

Internet Application Instructions

Internet and printing facilities are available in school daily during the registration period.

Approach General Office staff or look for our school's Tech Exec for assistance.

Note:

- 1) Facilities will NOT be available on Public Holidays and
- 2) Facilities will only be available in the mornings on eves of Public Holidays

Additional Information

Should you require further advice or assistance in your applications or future plans, please contact your teachers and/or ECG Counsellor.

For further inquiries, you may refer to the following hotlines and links for more information and advice on further education:

Institute of Technical Education (ITE)

ITE Hotline
(for ITE admissions and
courses)

1800 2222 111
training@ite.edu.sg

ECG Centre @ MOE

e-Appointment link

<https://go.gov.sg/moe-ecg-centre>



YEAR HEAD'S ADDRESS

Dear students,

You have worked hard to reach this stage. Let's celebrate your efforts!



Remember that
while **everyone's**
educational
journey is
different,
we can each have
a fulfilling
outcome!

Resources to support you as you receive your results

Receiving your results and making decisions about your post-secondary pathways can be exciting to some, but stressful to others.

Scan this QR code for an infographic with some helpful resources to support you.



<https://go.gov.sg/2025nlevelstudentresource>



Thinking about Your Next Step?

Consider these questions!

Where do I want to go?

Who am I?



How Do
I Get There?

Resources to help you make informed decisions

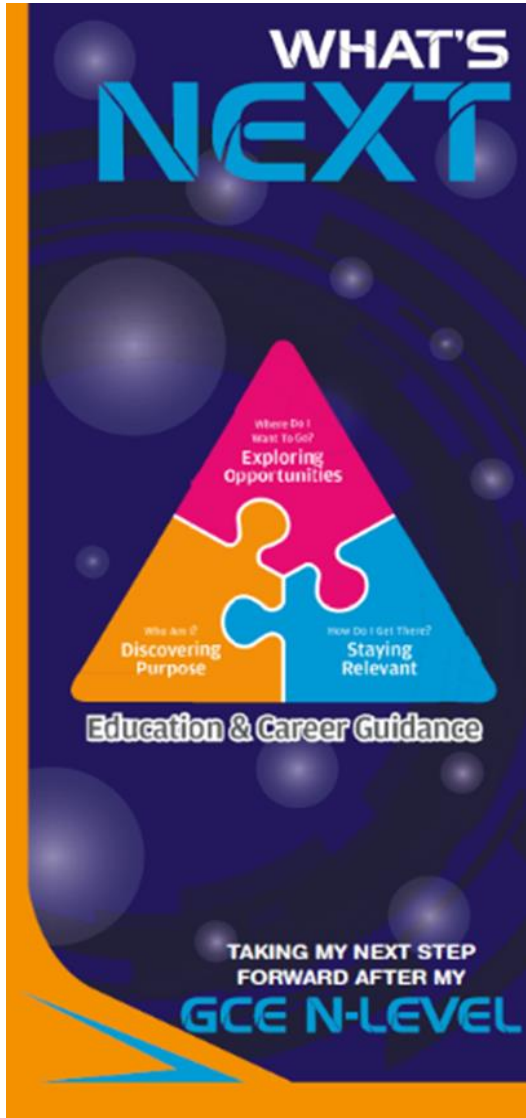

PLANNING YOUR NEXT STEP

These resources will help you chart your path ahead:



• What's Next Brochure

<https://go.gov.sg/whats-next-nlevel>



• Contact the ECG Centre @ MOE

<https://go.gov.sg/moe-ecg-centre>



• MySkillsFuture Student Portal

<https://go.gov.sg/MySFSec>



• Chat with your school's ECG Counsellor



About MySkillsFuture

A one-stop portal that empowers you to embark on a journey of self-discovery and make informed education and career choices. Use the information and tools to explore various education and career pathways, and take charge of your future.

MySkillsFuture Student Portal

Use the information and tools to explore various education and career pathways and take charge of your future.

Resources to help you make informed decisions

Learn more about the
admissions exercises
and programmes



<https://moe.gov.sg/post-secondary/admissions>

Learn more about the
post-secondary **education**
institutions



<https://moe.gov.sg/post-secondary/overview>

Concerned about your next steps?

Stop

- Calm yourself down. Take a few deep breaths.

Think

- Think through the different options that are available for you. Keep things in perspective.
- Remember that the N-Level is one part of your life journey and not the destination.

Do

- Approach a trusted adult and seek his/her help. Have a conversation with this person about what would be best for you.
- Make a decision and take action based on your options.

When you receive your results, you may experience a range of emotions.

Managing these emotions well will allow you to stay calm and make rational decisions.

Reaching out for help is a sign of strength, not weakness.

If you have any questions about your options or are not coping well, do reach out to someone you trust and speak with them. It could be a parent/guardian, teacher, ECG Counsellor, School Counsellor or a friend that you can talk to.



Make an appointment to speak with our
ECG Counsellor in JSS, Ms Ivy Nyam

OR

Make an ECG counselling appointment
via the **ECG Centre @ MOE**
<https://go.gov.sg/moe-ecg-centre>



Education & Career Guidance Appointment at JSS

Make an appointment by:

- 1) Clicking on this weblink
(<https://go.gov.sg/jss-ecg>)
- 2) Scanning this QR Code
- 3) Emailing to
ivy_nyam_lee_chin@schools.gov.sg



JSS ECG Counselor, Ms Ivy Nyam

Supporting Your Friend

Keep a lookout for your friends in distress. You can support them in the following ways:

Having difficult emotions during a stressful and uncertain period is normal. Keep a look out for some of these signs:

- D** Deliberately avoiding others
- I** Increased irritability, restlessness, agitation, stress and anxiety
- S** Sending or posting moody messages on social media
- T** Talking about death or dying
- R** Reacting differently or gradually losing interest in things they used to like
- E** Eating more than usual or having a much reduced appetite
- S** Sleep pattern changes with difficulty falling asleep or oversleeping
- S** Slowing down of energy levels

If you notice any of these signs in yourself or your friends,
have a chat with your School Counsellor or teacher,

Or contact SOS 24-hour hotline at **1767** or SOS 24-hour CareText Whatsapp at **91511767**
For cyber wellness related matters, call Help123 at **1800-612-3123*** or email **hello@help123.sg**

*available only from Mon to Fri (excluding Public Holidays), from 9am - 6pm.

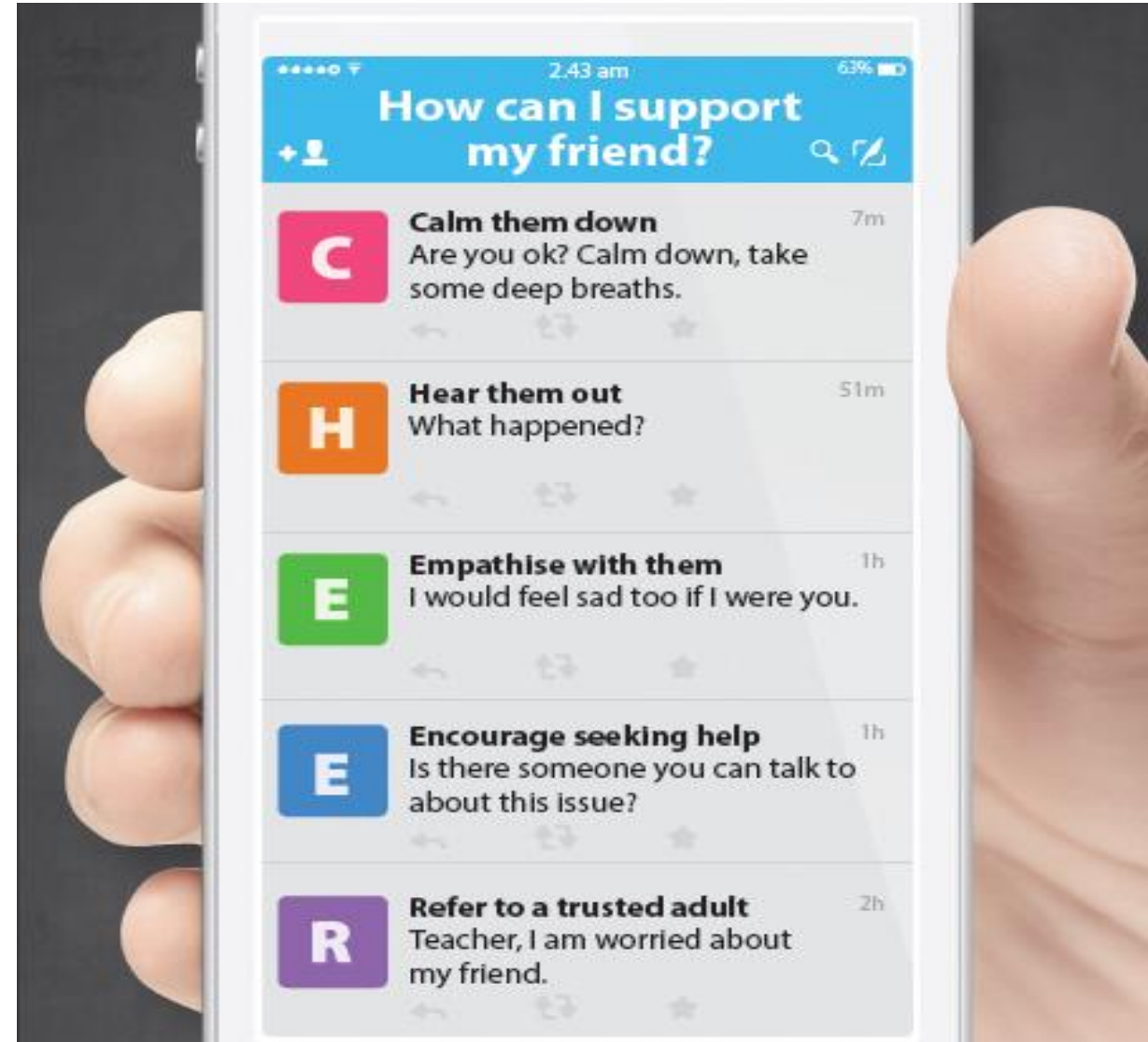

Support is readily available for you.

There are other hotlines and chats available if you are more comfortable seeking help using these platforms.

SOS provides round-the-clock emotional support for those in distress, thinking of suicide or affected by suicide.

Call: **1767**
(24-hour helpline)

WhatsApp: **9151 1767**
(24-hour Care Text)

Carey is an online platform by Care Corner that provides free mental health check-ins with mental health professionals. Find out more at: <https://carey.carecorner.org.sg/>

Community Health Assessment Team (CHAT) provides personalised and confidential mental health checks and consultation for youths. To speak with a youth support worker, you can:

Visit: **CHAT Hub at *Scape, 2 Orchard Link, #04-01A**
Call: **6493 6500 / 6501**
Email: chat@mentalhealth.sg

eC2 is an e-Counselling Centre where you can talk to a trained counsellor about the issues you are facing, right where you are.

Chat with a counsellor at: www.ec2.sg
Monday – Friday (Excluding Public Holidays): 10am – 12pm & 2pm – 5pm

Mindline is Singapore's national mental health helpline and textline service. The service is manned by trained counsellors who are ready to listen and support you.

Call: **1771**
(24-hour helpline)
WhatsApp: **6669 1771**
(24-Hour messaging service via WhatsApp)

TOUCHline is a helpline to provide youths with emotional support and practical advice.

Call: **1800 377 2252**
Monday- Friday (Excluding Public Holidays): 9am – 6pm





**The N-Level
examination is not
the destination.**

**It is part of your
education journey.**

RELEASE OF RESULTS

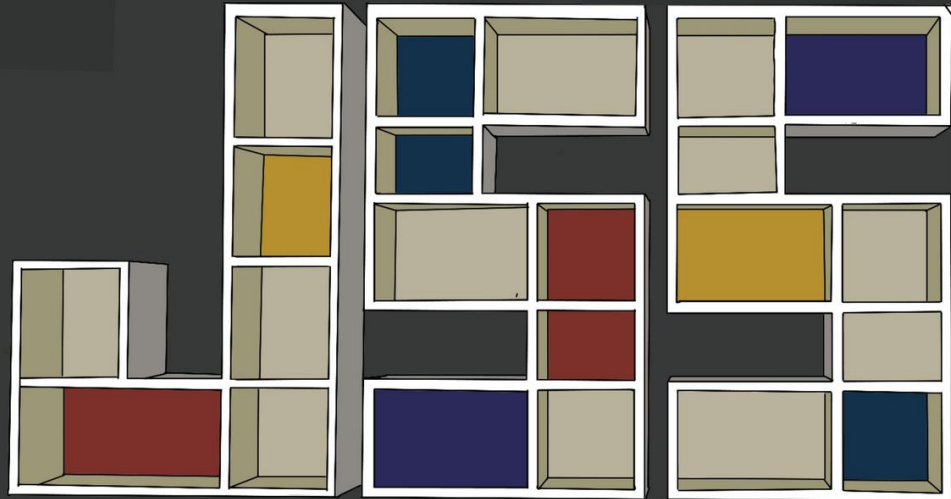

Every
Child a
Success
Story

